

**ITEM 5. ITEM FOR COMMITTEE INFORMATION – TRAFFIC TREATMENT –
PEDESTRIAN AND BICYCLE CROSSINGS – UNNAMED ROAD
ANNANDALE**

TRIM RECORD NO: 2015/439232

RECOMMENDATION

It is recommended that the Committee note the following traffic treatments on the Unnamed Road Annandale:

- (A) “Give Way” control on the unnamed road on approach to Nelson Street;
- (B) A raised marked pedestrian and cycle crossing with “Give Way” controls, west of Johnstons Creek;
- (C) A flush marked pedestrian crossing east of Johnstons Creek; and
- (D) The Developer to organise a post-construction Road Safety Audit following the completion of works.

DECISION

BACKGROUND

The Developer of the Rozelle Tram Sheds is proposing to introduce two marked pedestrian crossings on the unnamed road over Jonstones Creek to improve pedestrian access and safety to the surrounding parklands, the Glebe Foreshore and the Tram Sheds development.

The proposal was considered by the Committee at its meeting on 21 October 2015 with the decision to defer and consider the proposal out-of-session allowing for further investigation.

The proposal was unanimously endorsed by the Committee out-of-session on 4 December 2015 following further investigation from the City’s Risk Management team and an independent Road Safety Auditor.

COMMENTS

The unnamed road over Johnstons Creek intersects two walking and cycling paths along the eastern and western sides of Johnstons Creek. The walking and cycling paths provide access to surrounding parklands, the Glebe foreshore and the Tram Sheds development.

The unnamed road currently provides vehicular access to the Tram Sheds and will continue to do so following its redevelopment. In order to improve access and safety along the existing walking and cycling paths, it is proposed to introduce two marked pedestrian crossings across the unnamed road.

Recent pedestrian and traffic surveys showed that the proposed locations do not currently meet Roads and Maritime Services (RMS) warrants for marked pedestrian crossings. However, since the redevelopment of the Tram Sheds is still under construction, it is anticipated that RMS warrants would be achieved once the redevelopment is complete.

The proposal was referred to RMS who raised no objection to the two marked pedestrian crossings.

For further investigation, the proposal was reviewed by an independent Road Safety Auditor and referred to the City's Risk Management team who raised no objection to the proposal. The Road Safety Audit identified the inclusion of additional traffic treatments which has been incorporated into the proposal.

The proposal will be designed in accordance with Australian Standards, RMS guidelines and recommendations made by the Road Safety Auditor, and include lighting, advanced warning signs and linemarking.

A Road Safety Audit will be carried out following the construction of the marked pedestrian crossings.

CONSULTATION

The initial concept plans for the crossing were consulted with the community. There were 524 letters sent out with no submissions supporting the proposal and 10 submissions opposing the proposal.

Submissions opposing the proposal raised concerns about safety for pedestrians and cyclists due to an increase in vehicular traffic using the unnamed road following the redevelopment of the Tram Sheds.

The proposal has been reviewed by the City's Risk Management team, RMS and an independent Road Safety Auditor. The proposed pedestrian crossings will be designed in accordance with Australian Standards, RMS guidelines and recommendations made by the Road Safety Auditor, and include lighting, advanced warning signs and linemarking.

FINANCIAL

All costs associated with the proposal will be borne by the Developer.

ATTACHMENTS

Item for Committee Information – Traffic Treatment – Pedestrian and Bicycle Crossings – Unnamed Road Annandale

Rodney King, Senior Traffic Engineer

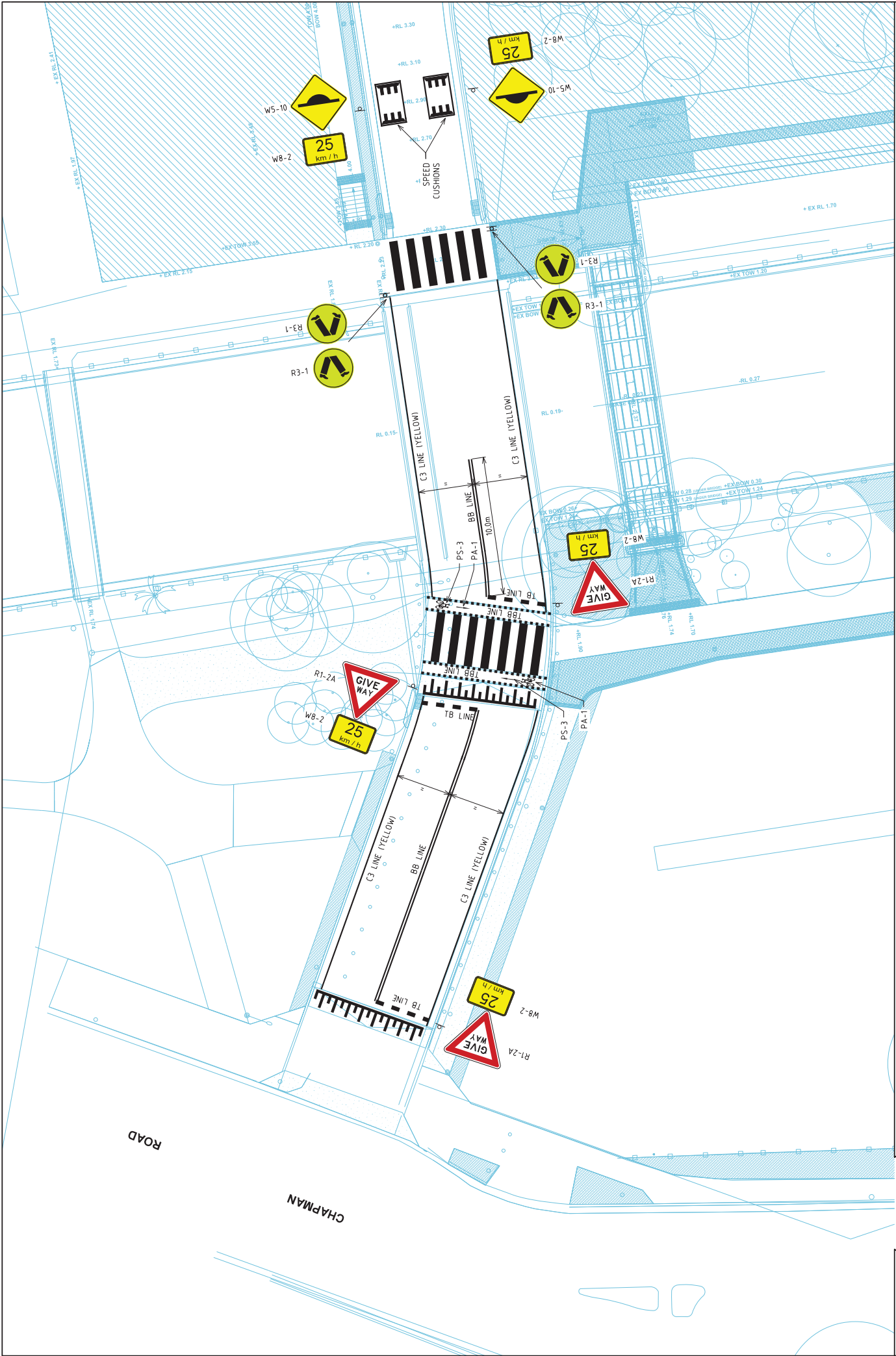

DATE: 16.11.2015
 SCALE: 1:250@A3
 DRAWING NO. 12S1324302-07-01-P4
 SHEET: 01 OF 01

HAROLD PARK TRAMSHED
 PROPOSED SIGNAGE AND LINEMARKING PLAN

PRELIMINARY PLAN
 FOR INFORMATION ONLY
 NOT TO BE USED FOR CONSTRUCTION



Melbourne 03 9551 9600
 Sydney 02 8446 1800
 Brisbane 07 5599 9600
 Canberra 02 6263 9600
 Adelaide 08 8334 3600

